

**TORNILLO DIN 7991 10.9 CINCADO**  
**ZINC PLATED SCREW DIN 7991 10.9**

**FICHA TÉCNICA**  
 TECHNICAL DATA SHEET

**Material / Material:** Acero / Steel  
**Recubrimiento / Coating:** Cincado / Zinc plated

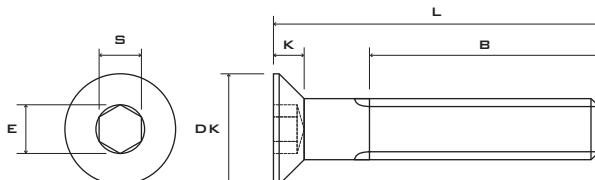
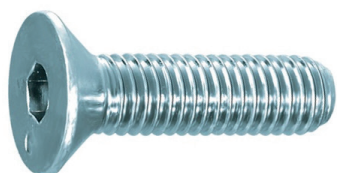

**MEDIDAS DISPONIBLES / AVAILABLE MEASURES**

Medidas en mm / Measures in mm

L	D	M3	M4	M5	M6	M8	M10	M12	M14	M16	M20
6		*	*	*							
8		*	*	*	*						
10		*	*	*	*	*					
12		*	*	*	*	*					
14		*	*	*	*	*					
16		*	*	*	*	*	*	*			
18		*	*	*	*	*	*	*			
20		*	*	*	*	*	*	*			
25		*	*	*	*	*	*	*		*	
30		*	*	*	*	*	*	*	*	*	
35		*	*	*	*	*	*	*	*	*	
40		*	*	*	*	*	*	*	*	*	*
45			*	*	*	*	*	*	*	*	*
50			*	*	*	*	*	*	*	*	*
50			*	*	*	*	*	*	*	*	*
60			*	*	*	*	*	*	*	*	*
70			*	*	*	*	*	*	*	*	*
80						*	*	*	*	*	*
90						*	*	*		*	*
100						*	*	*		*	*
110						*	*	*		*	*
120						*	*	*		*	*
130						*	*	*		*	*
140						*	*	*		*	*
150						*	*	*		*	*

DK	6,0	8,0	10,0	12,0	16,0	20,0	24,0	27,0	30,0	36,0
E	2,3	2,9	3,5	4,7	5,8	7,0	9,4	11,6	11,6	13,8
K	1,7	2,3	2,8	3,3	4,4	5,5	6,5	7,0	7,5	8,5
S	2,0	2,5	3,0	4,0	5,0	6,0	8,0	10,0	10,0	12,0
B (L ≤ 125)	12,0	14,0	16,0	18,0	22,0	26,0	30,0	34,0	38,0	46,0
B (L > 125)	-	-	-	24,0	28,0	32,0	36,0	40,0	44,0	52,0