

TORNILLO DIN 7991 10.9 / ISO 10642 CINCADO
 ZINC PLATED HEXAGON SOCKET COUNTERSUNK HEAD SCREW

FICHA TÉCNICA
 TECHNICAL DATA SHEET

Material / Material:
Recubrimiento / Coating:
Clase / Class:

Acero / Steel
 Cincado plata Cr3 5µm / Cr3 5µm Zinc plated
 10.9

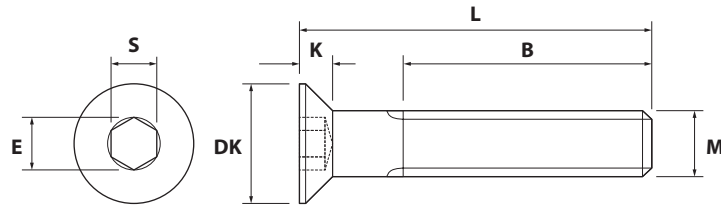
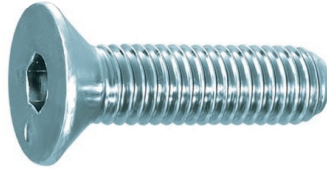

MEDIDAS DISPONIBLES / AVAILABLE MEASURES : *

MEDIDAS FUERA DE GAMA / OUT OF RANGE MEASURES : -

MxL (m.m.)	M3	M4	M5	M6	M8	M10	M12	M14	M16	M20
6	-	-	-	-	-	-	-	-	-	-
8	-	-	-	-	-	-	-	-	-	-
10	-	*	*	*	*	-	-	-	-	-
12	-	*	*	*	*	-	-	-	-	-
14	-	-	-	-	-	-	-	-	-	-
16	-	*	*	*	*	-	-	-	-	-
18	-	-	-	-	-	-	-	-	-	-
20	-	*	*	*	*	*	*	-	-	-
25	-	*	*	*	*	*	*	-	-	-
30	-	*	*	*	*	*	*	-	-	-
35	-	*	*	*	*	*	*	-	-	-
40	-	*	*	*	*	*	*	-	-	-
45	-	-	*	*	*	*	*	-	-	-
50	-	-	*	*	*	*	*	-	-	-
55	-	-	-	-	-	-	-	-	-	-
60	-	-	-	*	*	*	*	-	-	-
70	-	-	-	*	*	*	*	-	-	-
80	-	-	-	*	*	*	*	-	-	-
90	-	-	-	*	*	*	*	-	-	-
100	-	-	-	-	*	*	*	-	-	-
110	-	-	-	-	-	-	-	-	-	-
120	-	-	-	-	-	-	-	-	-	-
130	-	-	-	-	-	-	-	-	-	-
140	-	-	-	-	-	-	-	-	-	-
150	-	-	-	-	-	-	-	-	-	-

DK	6,0	8,0	10,0	12,0	16,0	20,0	24,0	27,0	30,0	36,0
E	2,3	2,9	3,5	4,7	5,8	7,0	9,4	11,6	11,6	13,8
K	1,7	2,3	2,8	3,3	4,4	5,5	6,5	7,0	7,5	8,5
S (Allen)	2,0	2,5	3,0	4,0	5,0	6,0	8,0	10,0	10,0	12,0
B (L≤125)	12,0	14,0	16,0	18,0	22,0	26,0	30,0	34,0	38,0	46,0
B (L>125)	-	-	-	24,0	28,0	32,0	36,0	40,0	44,0	52,0