

REMACHE STANDAR DIN 7337 CABEZA AVELLANADA ALUMINIO / ACERO ALUMINIUM / STEEL BLIND RIVET DIN 7337 COUNTERSUNK HEAD

FICHA TÉCNICA

TECHNICAL DATA SHEET

PARTE PART	MATERIAL MATERIAL	ACABADO FINISH
CUERPO BODY	ALUM. AL5050	PULIDO POLISHED
MANDRIL MANDREL	ACERO CARBONO CARBON STEEL	ACERO CINCADO CR3+ CR3+ ZINC PLATED STEEL

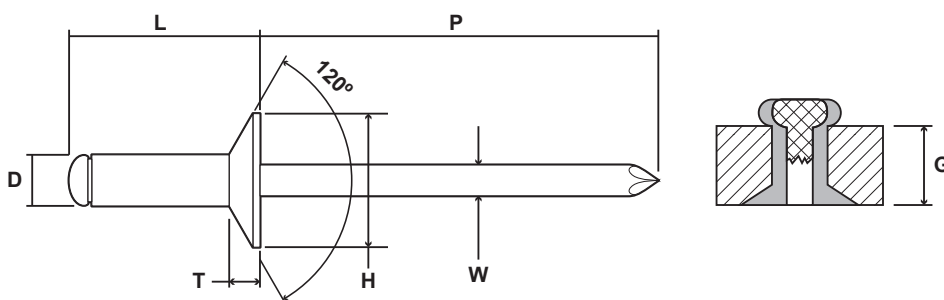

RAC

MEDIDA REMACHE RIVET MEASURE	Ø REMACHE RIVET Ø	Ø CABEZA HEAD Ø	ALTURA CABEZA HEAD HEIGHT	MAND. SALIENTE MAND. PROTRUSION	Ø MANDRIL MANDREL Ø	CIZALLA TÍPICA TYPICAL SHEAR	TENSIÓN TÍPICA TYPICAL TENSILE	Ø AGUJERO REC. REC. HOLE Ø
	(D) m.m.	(H) m.m.	(T) m.m.	MIN. (P) m.m.	NOM. (W) m.m.	MIN. N	MIN. N	m.m.
3,2	3,05-3,28	5,6-6,0	0,9	27	1,75	535	650	3,3-3,4
3,8	3,70-3,88	7,0-7,5	1,0	27	2,08	750	900	3,9-4,0
4,0	3,85-4,08	7,0-7,5	1,0	27	2,08	850	1.020	4,1-4,2
4,8	4,65-4,88	8,5-9,0	1,3	27	2,58	1.160	1.420	4,9-5,0

RESA / RESAA

MEDIDA REMACHE RIVET MEASURE	LONG. CUERPO BODY LENGTH	RANGO AGARRE GRIP RANGE
	(L) -0,1/+0,5 m.m.	(G) m.m.
3,2	6	1,0-3,0
	8	3,0-5,0
	10	5,0-7,0
	12	7,0-9,0
	15	10,0-12,0
	18	13,0-15,0
4,0	6	0,5-2,0
	8	2,0-4,0
	10	4,0-6,0
	12	6,0-8,0
	14	8,0-10,0
	16	10,0-12,0
	18	12,0-14,0
	20	14,0-16,0

MEDIDA REMACHE RIVET MEASURE	LONG. CUERPO BODY LENGTH	RANGO AGARRE GRIP RANGE
	(L) -0,1/+0,5 m.m.	(G) m.m.
4,8	6	0,5-1,5
	8	1,5-3,5
	10	3,5-5,5
	12	5,5-7,5
	14	7,5-9,5
	16	9,5-11,5
	18	11,5-13,5
	21	14,5-16,5
	24	17,5-19,5
	27	20,5-22,5
30	22,5-25,5	
35	28,5-30,5	