

REMACHE TUBULAR DIN 7337-B CABEZA AVELLANADA ALUMINIO/ACERO ALUMINUM/STEEL COUNTERSUNK HEAD BLIND RIVET DIN 7337-B

FICHA TÉCNICA TECHNICAL DATA SHEET



Cuerpo / Body	Aluminio AL5052 / Aluminum AL5052
Material / Material:	Pulido / Polish
Recubrimiento / Coating:	
Mandril / Mandrel	Acero carbono / Carbon steel
Material / Material:	Cindado plata Cr3 / Zinc plated Cr3
Recubrimiento / Coating:	

DATOS TÉCNICOS / TECHNICAL DATA

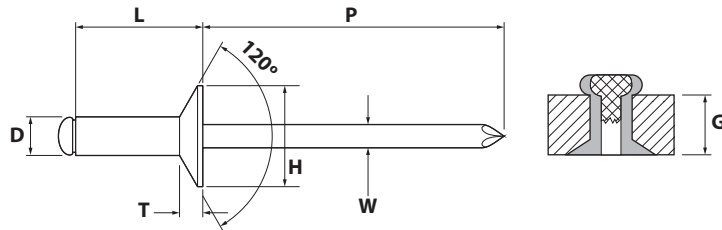

RAC

Ø	D	H	T	P min.	W nom.	CIZALLA TÍPICA Typical shear Cisaillement typique	TRACCIÓN TÍPICA Typical tensile Traction typique	Ø AGUJERO Hole Ø Ø Foret m.m.
m.m.	m.m.	m.m.	m.m.	m.m.	m.m.	N	N	m.m.
3,2	3,05-3,28	5,6-6,0	0,9	27	1,75	535	650	3,3-3,4
4,0	3,85-4,08	7,0-7,5	1,0	27	2,08	850	1.020	4,1-4,2
4,8	4,65-4,88	8,5-9,0	1,3	27	2,58	1.160	1.420	4,9-5,0

Ø	L	G
m.m.	-0,1/+0,5 m.m.	m.m.
3,2	6	1,0-3,0
	8	3,0-5,0
	10	5,0-7,0
	12	7,0-9,0
	15	10,0-12,0
4,0	18	13,0-15,0
	6	0,5-2,0
	8	2,0-4,0
	10	4,0-6,0
	12	6,0-8,0
	14	8,0-10,0
	16	10,0-12,0
18	12,0-14,0	
20	14,0-16,0	

Ø	L	G
m.m.	-0,1/+0,5 m.m.	m.m.
4,8	6	0,5-1,5
	8	1,5-3,5
	10	3,5-5,5
	12	5,5-7,5
	14	7,5-9,5
	16	9,5-11,5
	18	11,5-13,5
	21	14,5-16,5
	24	17,5-19,5
	27	20,5-22,5
30	22,5-25,5	
35	28,5-30,5	