

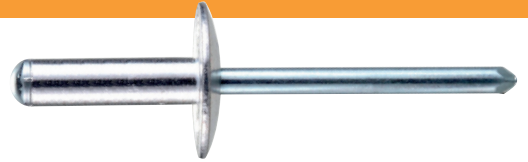



REMACHE TUBULAR DIN 7337 CABEZA ANCHA - ALUMINIO / ACERO



 ALUMINIUM / STEEL WIDE HEAD BLIND RIVET DIN 7337
 RIVET TUBULAIRE TÊTE LARGE DIN 7337 EN ALUMINIUM / ACIER
 BREITENKOPF-BLINDNIETE DIN 7337 AUS ALUMINIUM / STAHL

CAJA
ALUM. / ACERO

CÓDIGO CODE CODE	MEDIDA SIZE MEASURE m.m.			PRECIO TARIFA
				PRICE LIST PRIX TARIFS €/100 u.
RESAA3208	3,2x 8	500	10.000	7,50
RESAA3210	3,2x10	500	10.000	8,63
RESAA3212	3,2x12	500	10.000	9,30
RESAA4008	4,0x 8	500	10.000	6,47
RESAA4010	4,0x10	500	5.000	7,03
RESAA4012	4,0x12	500	5.000	8,80
RESAA4014	4,0x14	500	5.000	10,00
RESAA4016	4,0x16	500	5.000	10,97
RESAA4018	4,0x18	250	5.000	12,20
RESAA4020	4,0x20	250	5.000	14,70

ALUM. / ACERO

CÓDIGO CODE CODE	MEDIDA SIZE MEASURE m.m.			PRECIO TARIFA
				PRICE LIST PRIX TARIFS €/100 u.
RESAA4810	4,8x10	500	5.000	8,77
RESAA4812	4,8x12	500	5.000	9,30
RESAA4814	4,8x14	250	5.000	11,07
RESAA4816	4,8x16	250	5.000	11,97
RESAA4818	4,8x18	250	2.500	13,27
RESAA4821	4,8x21	250	2.500	15,03
RESAA4824	4,8x24	250	2.500	16,80
RESAA4827	4,8x27	200	2.000	17,83
RESAA4830	4,8x30	200	2.000	19,70
RESAA4835	4,8x35	200	2.000	22,57

BLISTERS
ALUM. / ACERO

CÓDIGO CODE CODE	MEDIDA SIZE MEASURE m.m.			PRECIO TARIFA
				PRICE LIST PRIX TARIFS €/BLISTER
BRESAA4010	4,0x10	8	20	1,60
BRESAA4012	4,0x12	8	20	1,60
BRESAA4016	4,0x16	8	20	1,60
BRESAA4810	4,8x10	8	20	1,60
BRESAA4812	4,8x12	8	20	1,60
BRESAA4814	4,8x14	8	20	1,60
BRESAA4816	4,8x16	8	20	1,60
BRESAA4818	4,8x18	5	20	1,60

**PEDIDO MÍNIMO 1 EMBALAJE
MINIMUM ORDER 1 PACKAGING**

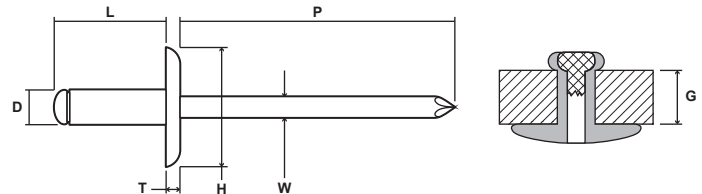
 INFORMACIÓN TÉCNICA
 TECHNICAL INFORMATION
 INFORMATION TECHNIQUE
 TECHNISCHE INFORMATIONEN
 REF.: RESA / RESAA

RESAA

MEDIDA REMACHE / CABEZA MEASURE RIVET / HEAD	Ø REMACHE RIVET Ø	Ø CABEZA HEAD Ø	ALTURA CABEZA HEAD HEIGHT	MAND. SALIENTE MAND. PROTRUSION	Ø MANDRIL MANDREL Ø	CIZALLA TÍPICA TYPICAL SHEAR	TENSIÓN TÍPICA TYPICAL TENSILE	Ø AGUJERO REC. REC. HOLE Ø
	(D) m.m.	(H) m.m.	(T) m.m.	MIN. (P) m.m.	NOM. (W) m.m.	MIN. N	MIN. N	m.m.
3,2 / 9,6	3,05-3,28	8,8-9,8	1,2-1,6	27	1,81	535	650	3,3-3,4
4,0 / 10	3,85-4,08	9,0-10,5	1,4-1,9	27	2,18	850	1.020	4,1-4,2
4,0 / 12	3,85-4,08	11,0-12,5	1,4-1,9	27	2,18	850	1.020	4,1-4,2
4,8 / 11	4,65-4,88	10,0-11,5	1,5-2,3	27	2,68	1.160	1.420	4,9-5,0
4,8 / 14	4,65-4,88	13,0-14,5	1,5-2,3	27	2,68	1.160	1.420	4,9-5,0
4,8 / 16	4,65-4,88	15,0-16,5	1,5-2,3	27	2,68	1.160	1.420	4,9-5,0
5,0 / 11	4,85-5,08	10,0-11,5	1,5-2,3	27	2,68	1.320	1.610	5,1-5,2
5,0 / 14	4,85-5,08	13,0-14,5	1,5-2,3	27	2,68	1.320	1.610	5,1-5,2
5,0 / 16	4,85-5,08	15,0-16,5	1,5-2,3	27	2,68	1.320	1.610	5,1-5,2
6,4 / 19	6,25-6,48	17,5-19,0	2,4-2,9	30	3,80	2.050	2.500	6,5-6,6