





GANCHO DE ELEVACIÓN CON SEGURO - GRADO 40

 CARBON STEEL EYE HOOKS WITH LATCH
 CROCHETS DE LEVAGE EN ACIER CARBONE AVEC LINGUET
 HAKEN KOHLENSTOFFSTAHL MIT SICHERUNG



GRADO 40





CAJA / BOX / BOÎTE 

GRADO 40 / GRADE 40

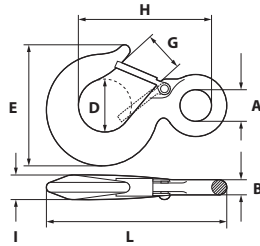
CÓDIGO Code / Code	MEDIDA Measure / Mesure * CMU Tn	A m.m.	B m.m.	D m.m.	E m.m.	G m.m.	H m.m.	I m.m.	L m.m.	PESO Weight / Poids	
										Kg.	
GESA08	0,8	19	10	30	73	21,5	80	15	110	0,26	50
GESA10	1,0	23	12	32	82	23	93	17,5	125	0,35	50
GESA16	1,6	27	13	35	93	23	103	20,5	142	0,62	30
GESA20	2,0	30	16	38	105	24	117	22	165	0,93	25
GESA32	3,2	38	19	46	125	26,5	145	28,5	204	1,73	10



GANCHO DE ELEVACIÓN CON SEGURO GIRATORIO - GRADO 40

 CARBON STEEL REVOLVING HOOKS WITH LATCH
 CROCHETS A EMERILLON EN ACIER CARBONE AVEC LINGUET
 LASTHAKEN KOHLENSTOFFSTAHL MIT SICHERUNG



GRADO 40



CAJA / BOX / BOÎTE 

GRADO 40 / GRADE 40

CÓDIGO Code / Code	MEDIDA Measure / Mesure * CMU Tn	A m.m.	B m.m.	C m.m.	D m.m.	E m.m.	F m.m.	G m.m.	H m.m.	I m.m.	L m.m.	L1 m.m.	d m.m.	PESO Weight / Poids	
														Kg.	
GESGA10	1,0	38	13	34	82	34	81	27	26	86	170	135,5	M16	0,77	30
GESGA20	2,0	50	18	47	110	48	104	32	21,5	106	219	173	M20	1,51	15
GESGA32	3,2	57	20	55	127	54	125	38	28,5	133	262	205	M22	2,48	5

